

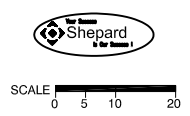

SEPTEMBER 11-12, 2012 - CHICAGO NAVY PIER - HALL A

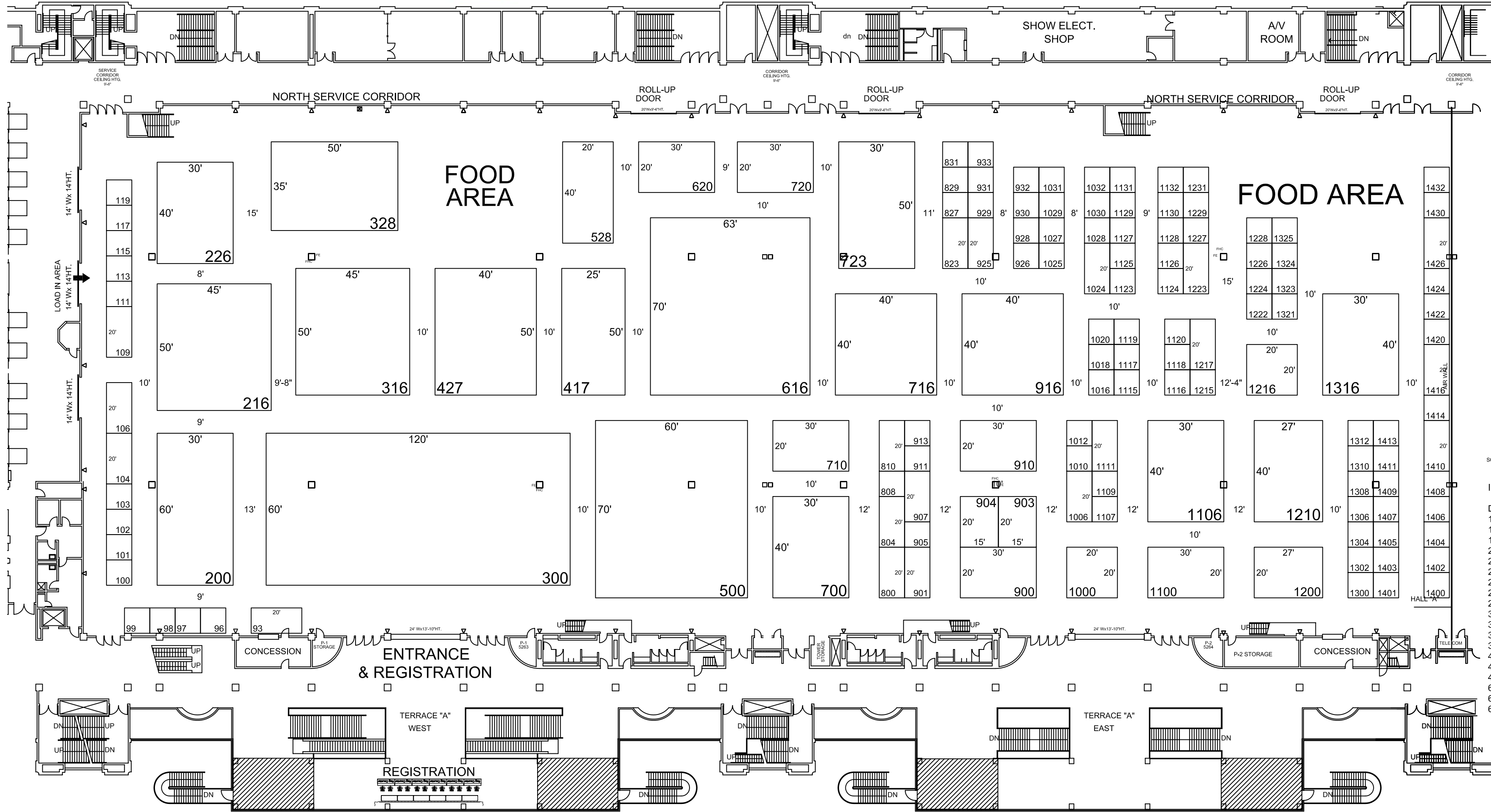

Inventory as of 09/05/2012

Dimension	Size	Qty	SqFt
10'x10'	100	94	9,400
10'x20'	200	19	3,800
15'x20'	300	2	600
20'x20'	400	2	800
20'x27'	540	1	540
20'x30'	600	6	3,600
20'x40'	800	1	800
25'x50'	1,250	1	1,250
27'x40'	1,080	1	1,080
30'x40'	1,200	4	4,800
30'x50'	1,500	1	1,500
30'x60'	1,800	1	1,800
35'x50'	1,750	1	1,750
40'x40'	1,600	2	3,200
40'x50'	2,000	1	2,000
45'x50'	2,250	2	4,500
60'x120'	7,200	1	7,200
60'x70'	4,200	1	4,200
63'x70'	4,410	1	4,410
Totals:	142	57,231	

1/32" = 1'-0"